

MABUSELA VILLAGE ROAD 1 ROAD SIGNS			
CODE	NAME	No.	SIZE (mm)
R1	STOP	6	450

ALL DIMENSIONS AND LEVELS ARE TO BE VERIFIED ON SITE BY THE CONTRACTOR BEFORE COMMENCING ANY WORK.

This document and all the information thereon remains the property of ROMH and may not be copied, reproduced or transmitted in part or in full without the written consent of ROMH. This document should not be relied on nor used in circumstances other than those for which it was originally prepared and for which ROMH was commissioned, as defined on this document. Refer to the contract for full terms and conditions.

ROMH shall not be liable for the consequences of using this document other than for the purpose for which it was commissioned. Any user and any other person using or relying on the document for such other purpose, will by such use or reliance be taken to confirm his agreement to indemnify ROMH for all loss or damage resulting there from.

ON ORIGINAL

GENERAL NOTES:

- CONTRACTOR TO ENSURE ACCESS TO RESIDENTIAL STANDS AT ALL TIMES DURING CONSTRUCTION
- THE ONUS REST UPON THE CONTRACTOR TO IDENTIFY SPOIL AND TEMPORARY STOCKPILE AREAS IN THE VICINITY OF THE WORKS
- THE ONUS REST UPON THE CONTRACTOR TO VERIFY THE POSITION OF EXISTING SERVICES AND TO EXPOSE AND PROTECT THESE SERVICES BEFORE COMMENCING WITH THE WORKS

ROAD MARKING & ROAD SIGNAGE:

- COLD PLASTIC MATERIAL TO BE USED ON ALL ROAD MARKING.
- ALL GMT ROAD MARKINGS TO BE 2.5m.
- ALL SIGN POSTS TO BE GALVANISED STEEL.
- ALL ROAD SIGN POSTS TO BE 2.1m FROM GROUND SURFACE UNLESS SPECIFIED ON THE DRAWINGS.
- PLACING OF ROAD SIGNS TO ENGINEERS SITE INSTRUCTION AND SHOULD MEET UNIVERSAL ACCESS REQUIREMENTS.

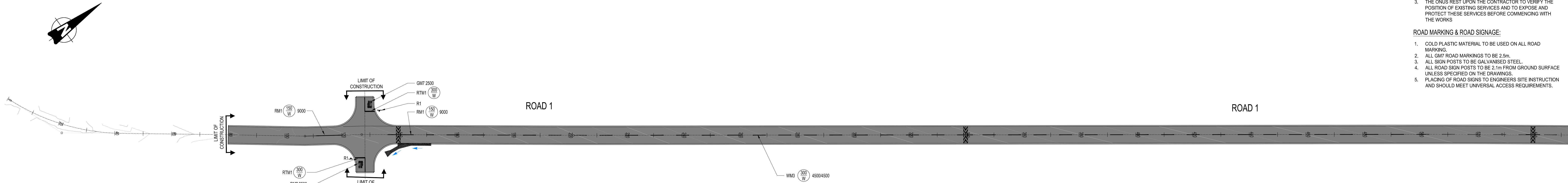

MABUSELA VILLAGE ROAD 1_PROPOSED ROAD MARKING LAYOUT
SCALE 1:500

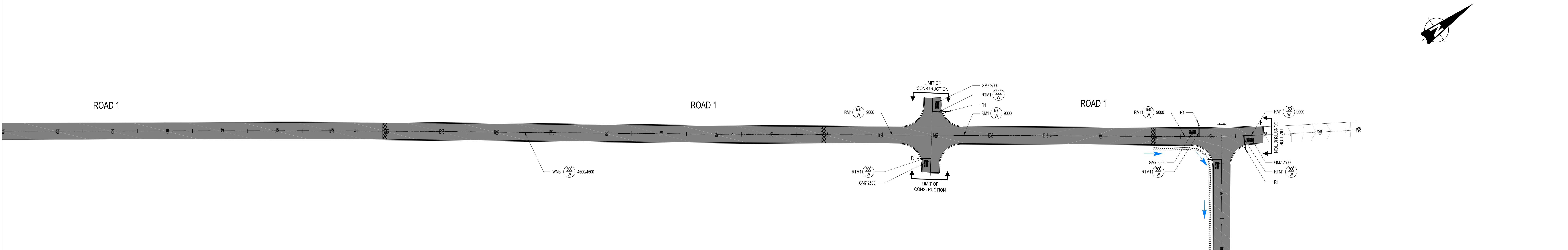
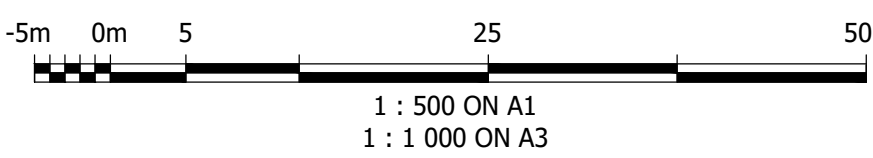

MABUSELA VILLAGE ROAD 1_PROPOSED ROAD MARKING LAYOUT
SCALE 1:500

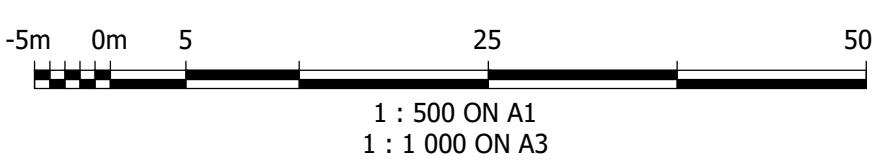

FOR TENDER

CLIENT:



54 Relief Street
Mokopane
0801

PROJECT:

CONTRACT No. :
UPGRADING OF GRAVEL ROADS AND STORMWATER IN
MOORDKOPPIE CLUSTER AT MABUSELA AND MASOGE VILLAGES

DESIGN COORDINATOR APPROVAL:

SIGNATURE _____ DATE _____

PROJECT MANAGER APPROVAL:

SIGNATURE _____ DATE _____

CLIENT APPROVAL:

SIGNATURE _____ DATE _____

A	SEP. 2020	ISSUED FOR TENDER PURPOSE ONLY	MLM
REV	DATE	DESCRIPTION	DRAWN

REVISIONS

DRAWN: ML. MATHEGA	CHECKED: S. SITHOLE	DESIGNED: A. JUBA
SCALES: AS SHOWN	DATE: SEPTEMBER 2020	
DRAWING TITLE:	MABUSELA VILLAGE: ROAD 1_ROAD MARKING LAYOUT	
SIZE: A0	PROJECT No.	
REV No. A	DRAWING No.	ROMH-042-07-04-01

CONSULTANTS:



ROMH HOUSE
WHITBY MANOR OFFICE PARK
167 14 ROAD, NOORDWYK
MIDRAND

Tel: (010) 035 1460
Email: info@romh.co.za
Web: www.romh.co.za